

UNIT, DIRECT SUPPORT, AND GENERAL SUPPORT MAINTENANCE  
REPAIR PARTS AND SPECIAL TOOLS LIST

EXTENDED SERVICE PROGRAM (ESP)

TRUCK, CARGO, 2-1/2-TON, 6X6, M44A3 SERIES TRUCKS (DIESEL)

M35A3, W/WINCH (NSN 2320-01-383-3850);

M35A3C, W/WINCH (NSN 2320-01-383-2049);

M36A3, W/WINCH (NSN 2320-01-383-2046).

10 — 11

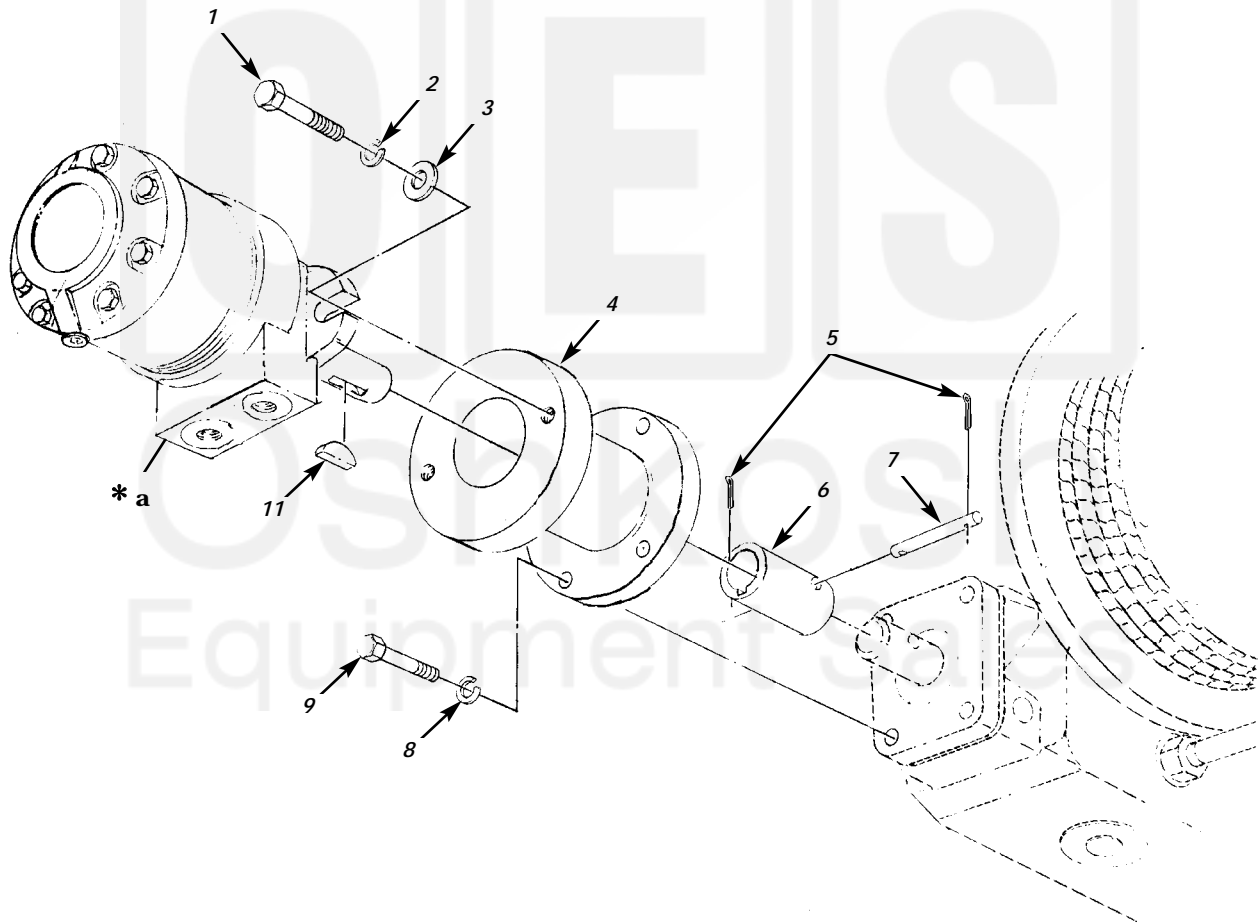

\* a PART OF ITEM 10

Figure 143. Winch Motor and Related Parts.

Current part is item (6) on diagram. Available at [www.oshkoshequipment.com](http://www.oshkoshequipment.com)

(1) ITEM NO	(2) SMR CODE	(3) NSN	TM9-2320-386-24P (4) CAGEC	(5) PART NUMBER	(6) DESCRIPTION AND USABLE ON CODES(UC)	0144 00 (7) QTY
GROUP 2001 HOIST,CAPSTAN,WINDLASS, CRANE OR WINCH ASSEMBLY						
FIG. 143 WINCH MOTOR AND RELATED PARTS						
1	PAOZZ	5305007098539	96906	MS90727-89	SCREW,CAP,HEXAGON H..... UC:ESP,ESR,EST	2
2	PAOZZ	5310002090965	96906	MS35338-47	WASHER,LOCK..... UC:ESP,ESR,EST	2
3	PAOZZ	5310012577590	96906	MS51412-7	WASHER,FLAT..... UC:ESP,ESR,EST	2
4	PAOZZ	3040014413501	19207	12448891	ADAPTER,HOUSING..... UC:ESP,ESR,EST	1
5	PAOZZ	5315008395820	96906	MS24665-134	PIN,COTTER..... UC:ESP,ESR,EST	2
6	PAOZZ	3010014416323	19207	12448907	COUPLING,SHAFT,RIGI..... UC:ESP,ESR,EST	1
7	PAOZZ	5315014412294	19207	12448905	PIN,STRAIGHT,HEADLE..... UC:ESP,ESR,EST	1
8	PAOZZ	5310000034094	01276	210104-8S	WASHER,LOCK..... UC:ESP,ESR,EST	4
9	PAOZZ	5305000712072	80204	B1821BH050C225N	SCREW,CAP,HEXAGON H..... UC:ESP,ESR,EST	4
10	PAOZZ	4320014417669	06495	M30-106-7AS	MOTOR-PUMP,HYDRAULI..... UC:ESP,ESR,EST	1
11	PAOZZ	5315014084856	0ACY8	1655	.KEY,WOODRUFF..... UC:ESP,ESR,EST	1

END OF FIGURE

Oshkosh  
Equipment Sales

0144 00-1

Current part is item (6) on diagram. Available at [www.oshkoshequipment.com](http://www.oshkoshequipment.com)